



**BARCODE TECHNOLOGIES**

**WPS200**



Quick Reference Guide — Guida Rapida  
Guide de Référence Rapide — Guía de Referencia Rápida  
Schnellanleitung — Referência Rápida

Wasp Barcode Technologies  
1400 10th Street  
Plano, Texas USA 75074  
Tel. 214-547-4100  
Tel. 214-547-4101

©2009-2013 Wasp Barcode Technologies, Inc. (an unpublished work provided under license).

This product may be covered by one or more of the following patents:

4603262 • 4639606 • 4652750 • 4672215 • 4699447 • 4709369 • 4749879 • 4786798 • 4792666 • 4794240 • 4798943  
• 4799164 • 4820911 • 4845349 • 4861972 • 4861973 • 4866257 • 4868836 • 4879456 • 4939355 • 4939356 •  
4943127 • 4963719 • 4971176 • 4971177 • 4991692 • 5001406 • 5015831 • 5019697 • 5019698 • 5086879 • 5115120  
• 5144118 • 5146463 • 5179270 • 5198649 • 5200597 • 5202784 • 5208449 • 5210397 • 5212371 • 5212372 •  
5214270 • 5229590 • 5231293 • 5232185 • 5233169 • 5235168 • 5237161 • 5237162 • 5239165 • 5247161 • 5256864  
• 5258604 • 5258699 • 5260554 • 5274219 • 5296689 • 5298728 • 5311000 • 5327451 • 5329103 • 5330370 •  
5347113 • 5347121 • 5371361 • 5382783 • 5386105 • 5389917 • 5410108 • 5420410 • 5422472 • 5426507 • 5438187  
• 5440110 • 5440111 • 5446271 • 5446749 • 5448050 • 5463211 • 5475206 • 5475207 • 5479011 • 5481098 •  
5491328 • 5493108 • 5504350 • 5508505 • 5512740 • 5541397 • 5552593 • 5557095 • 5563402 • 5565668 • 5576531  
• 5581707 • 5594231 • 5594441 • 5598070 • 5602376 • 5608201 • 5608399 • 5612529 • 5629510 • 5635699 •  
5641958 • 5646391 • 5661435 • 5664231 • 5666045 • 5671374 • 5675138 • 5682028 • 5686716 • 5696370 • 5703347  
• 5705802 • 5714750 • 5717194 • 5723852 • 5750976 • 5767502 • 5770847 • 5786581 • 5786585 • 5787103 •  
5789732 • 5796222 • 5804809 • 5814803 • 5814804 • 5821721 • 5822343 • 5825009 • 5834708 • 5834750 • 5837983  
• 5837988 • 5852286 • 5864129 • 5869827 • 5874722 • 5883370 • 5905249 • 5907147 • 5923023 • 5925868 •  
5929421 • 5945670 • 5959284 • 5962838 • 5979769 • 6000619 • 6006991 • 6012639 • 6016135 • 6024284 • 6041374  
• 6042012 • 6045044 • 6047889 • 6047894 • 6056198 • 6065676 • 6069696 • 6073849 • 6073851 • 6094288 •  
6112993 • 6129279 • 6129282 • 6134039 • 6142376 • 6152368 • 6152372 • 6155488 • 6166375 • 6169614 • 6173894  
• 6176429 • 6188500 • 6189784 • 6213397 • 6223986 • 6230975 • 6230976 • 6244510 • 6259545 • 6260763 •  
6266175 • 6273336 • 6276605 • 6279829 • 6290134 • 6290135 • 6293467 • 6303927 • 6311895 • 6318634 • 6328216  
• 6332576 • 6332577 • 6343741 • 6454168 • 6478224 • 6568598 • 6578765 • 6705527 • 6857567 • 6974084 •  
6991169 • 7051940 • 7170414 • 7172123 • 7201322 • 7204422 • 7215493 • 7224540 • 7234641 • 7243850 • 7374092  
• 7407096 • 7490770 • 7495564 • 7506816 • 7527198 • 7527207 • 7537166 • 7562817 • 601 26 118.6 • AU703547 •  
D312631 • D313590 • D320011 • D320012 • D323492 • D330707 • D330708 • D349109 • D350127 • D350735 •  
D351149 • D351150 • D352936 • D352937 • D352938 • D352939 • D358588 • D361565 • D372234 • D374630 •  
D374869 • D375493 • D376357 • D377345 • D377346 • D377347 • D377348 • D388075 • D446524 • D606544  
• EP0256296 • EP0260155 • EP0260156 • EP0295936 • EP0325469 • EP0349770 • EP0368254 • EP0442215 •  
EP0498366 • EP0531645 • EP0663643 • EP0698251 • EP01330772 • EP870761 • GB2252333 • GB2284086 •  
GB2301691 • GB2304954 • GB2307093 • GB2308267 • GB2308678 • GB2319103 • GB2333163 • GB2343079 •  
GB2344486 • GB2345568 • GB2354340 • ISR107546 • ISR118507 • ISR118508 • JP1962823 • JP1971216 • JP2513442  
• JP2732459 • JP2829331 • JP2953593 • JP2964278 • MEX185552 • MEX187245 • RE37166 • RE40071

Additional patents pending.

# Table of Contents



<b>English .....</b>	<b>1</b>
<b>Italiano .....</b>	<b>5</b>
<b>Español .....</b>	<b>9</b>
<b>Portugues .....</b>	<b>13</b>
<b>Francais .....</b>	<b>17</b>
<b>Deutsch .....</b>	<b>21</b>

# NOTES

# END USER LICENSE AGREEMENT

**Notice to End User:** The Product you have acquired contains embedded Software, which is integral to the product's operation. This Software is being provided to you under license, subject to the terms and conditions of this Agreement. If you use the Wasp Barcode Technologies (Wasp) Product, you will be deemed to have accepted the terms and conditions of this Agreement. If you do not intend to be bound to the terms of this Agreement, Wasp is not willing to license the Software to you, you may not use the Wasp Product or the Software, and you must contact the party from whom you acquired the Wasp Product for instructions.

This End User Software License Agreement ("Agreement") is a legally binding agreement governing the licensing of the Software and Documentation by Wasp Barcode Technologies, Inc. ("Wasp") to the entity or person who has purchased or otherwise acquired a Wasp Product ("End User"). For purposes of this Agreement, any software that is associated with a separate end-user license agreement is licensed to you under the terms of that license agreement. Wasp and End User hereby agree as follows:

## 1. Definitions.

- 1.1 "Documentation" means materials such as user's guides, program reference guides, quick reference guides, manuals, or similar materials associated with or related to the Wasp Product, whether in printed, "online", or other form.
- 1.2 "Proprietary Information" means: (a) source code, object code, software, documentation, and any related internal design, system design, data base design, algorithms, technology, technical data or information, implementation techniques, and trade secrets related to the Software, (b) any other trade secrets marked appropriately or identified as proprietary or confidential, and (c) any information that End User, under the circumstances, should recognize as confidential. Proprietary Information does not include any information that the receiving party can establish was (1) in the public domain, (2) already in the receiving party's possession or rightfully known prior to receipt, (3) rightfully learned from a third party not in violation of any other's proprietary rights, or (4) independently developed without access to Proprietary Information.
- 1.3 "Wasp Product" means the Wasp WPS200 product, including all embedded Software in and all Documentation related to such product, which has been purchased or otherwise acquired by End User, whether obtained directly or indirectly from Wasp.
- 1.4 "Software" means any software or computer programs of Wasp or its third party licensors in machine readable form which is embedded in the Wasp Product, whether obtained directly or indirectly from Wasp, including any replacement, update, upgrade, enhancement or modification.

## 2. Scope Of License Granted.

- 2.1 Wasp grants to End User a non-exclusive, non-transferable, perpetual license to use the Software, solely on the Wasp Product in which it is embedded ("designated Wasp Product"), in machine-readable form only, solely for End User's internal business purposes. This Agreement does not convey ownership of the Software to End User. Title to the Software shall be and remain with Wasp or the third party from whom Wasp has obtained a licensed right. As used in this Agreement, the term "purchase" or its equivalents when applied to the Software shall mean "acquire under license." End User is not entitled to receipt or use of the source code to any Software.
- 2.2 End User shall not copy, modify, decompile, disassemble, reverse engineer, or otherwise reproduce or remanufacture the Software, whether modified or unmodified, nor sell, assign, sublicense, distribute, lend, rent, give, or otherwise transfer the Software to any other person or organization, for purposes other than as expressly provided in this Agreement, without Wasp's prior written consent.

## 3. Transfers, Support.

- 3.1 Any copying, installing, reproduction, remanufacture, reverse engineering, electronic transfer, or other use of the Software on other than the designated Wasp Product will be a material breach of this Agreement. However, Wasp may elect not to terminate this Agreement or the granted licenses, but instead may elect to notify End User that End

User is deemed to have ordered and accepted a license for each breaching use. End User shall pay Wasp the applicable list price for such licenses as of the date of such breach.

- 3.2 End User shall not sell, assign, sublicense, distribute, lend, rent, give, or otherwise transfer the Wasp Product to any third party unless such third party agrees with Wasp in writing to be bound by the terms and conditions of this Agreement. Any such transfer of the Wasp Product absent such agreement shall be null and void.
- 3.3 End User may obtain support for Software from Wasp at Wasp's standard support fees and under Wasp's standard support terms and conditions in effect at the time the support is requested.

#### **4. Intellectual Property.**

End User acknowledges that the Software constitutes valuable trade secrets of Wasp or Wasp's third party licensors and that the Software is protected by intellectual property laws and treaties. The license set forth in this Agreement does not transfer to End User any ownership of Wasp's or its third party licensors' copyrights, patents, trademarks, service marks, trade secrets, or other intellectual property rights and End User shall have no right to commence any legal actions to obtain such rights. End User shall not remove, modify, or take any other action that would obscure any copyright, trademark, patent marking, or other intellectual property notices contained in or on the Wasp Product.

#### **5. Proprietary Information.**

- 5.1 End User acknowledges that Proprietary Information is the confidential, proprietary, and trade secret property of Wasp and Wasp's third party licensors and End User acquires no right or interest in any Proprietary Information.
- 5.2 End User shall not disclose, provide, or otherwise make available the Proprietary Information of Wasp or its third party licensors to any person other than End User's authorized employees or agents who are under confidentiality agreement, and End User shall not use the Proprietary Information other than in conjunction with use of the Wasp Product exclusively for End User's internal business purposes. End User shall take steps to protect the Proprietary Information no less securely than if it were End User's own intellectual property.
- 5.3 The provisions of this Proprietary Information Section shall survive and continue for five (5) years after the termination of this Agreement.

#### **6. Limited Warranty.**

- 6.1 Wasp warrants that, under normal use and operation, the Wasp Product will conform substantially to the applicable Documentation for the period specified in the Documentation. During this period, for all reproducible nonconformities for which Wasp has been given written notice, Wasp will use commercially reasonable efforts to remedy nonconformities verified by Wasp. End User agrees to supply Wasp with all reasonably requested information and assistance necessary to help Wasp in remedying such nonconformities. For all defects reported to Wasp within the warranty period, Wasp's liability is limited to providing End User with one copy of corrections or responding to End User's problem reports according to Wasp's standard assistance practices. Wasp does not warrant that the product will meet End User's requirements or that use of the product will be uninterrupted or error free, or that Wasp's remedial efforts will correct any nonconformance. This limited warranty does not cover any product that has been subjected to damage or abuse, whether intentionally, accidentally, or by neglect, or to unauthorized repair or unauthorized installation, and shall be void if End User modifies the product, uses the product in any manner other than as established in the Documentation, or if End User breaches any of the provisions of this Agreement.
- 6.2 EXCEPT AS PROVIDED IN THIS AGREEMENT, THE WASP PRODUCT IS PROVIDED "AS IS" AND WASP MAKES NO WARRANTIES OF ANY KIND, EXPRESS OR IMPLIED, WRITTEN OR ORAL, WITH RESPECT TO THE PRODUCT, AND SPECIFICALLY DISCLAIMS THE IMPLIED WARRANTIES OF MERCHANTABILITY AND FITNESS FOR A PARTICULAR PURPOSE.

#### **7. Infringement.**

- 7.1 Wasp will defend End User against any claim in a lawsuit that the Wasp Product furnished hereunder infringe a United States patent or copyright of a third party and Wasp will pay any damages finally awarded against End User by a court of competent jurisdiction that are attributable to such claim or will pay End User's part of any settlement that is

attributable to such claim, provided, that 1) End User notifies Wasp promptly in writing of the claim, 2) Wasp controls the defense or settlement of the claim, and 3) End User cooperates fully with Wasp in such defense or settlement. All notices of a claim should be sent to Wasp Barcode Technologies, Inc., 1400 10th Street, Plano, Texas USA 75074.

- 7.2 In the defense or settlement of any such claim, Wasp may, at its option, 1) procure for End User the right to continue using the Wasp Product, 2) modify the Wasp Product so that it becomes non-infringing, 3) replace the Wasp Product with an equivalent product not subject to such claim, or 4) provide End User an opportunity to return the Wasp Product and receive a refund of the purchase price paid, less a reasonable allowance for use.
- 7.3 Wasp shall have no liability to End User for claims of infringement based upon 1) the use of any Wasp Product in combination with any product which Wasp has not either furnished or authorized for use with such Wasp Product 2) the use of any Wasp Product designed, manufactured, or modified to the specifications of End User, or 3) End User's modification of the Wasp Product without written authorization from Wasp.
- 7.4 THE FOREGOING STATES WASP'S COMPLETE AND ENTIRE OBLIGATION CONCERNING CLAIMS OF PATENT, COPYRIGHT, OR OTHER INTELLECTUAL PROPERTY INFRINGEMENT, CANCELS AND SUPERSEDES ANY PRIOR AGREEMENTS, WHETHER ORAL OR WRITTEN, BETWEEN THE PARTIES CONCERNING SUCH CLAIMS, AND WILL NOT BE MODIFIED OR AMENDED BY ANY PAST, CONTEMPORANEOUS, OR FUTURE AGREEMENTS OR DEALINGS BETWEEN THE PARTIES, WHETHER ORAL OR WRITTEN, EXCEPT AS SET FORTH IN A FUTURE WRITING SIGNED BY BOTH PARTIES.

## **8. Limitation Of Liability.**

EXCEPT AS PROVIDED IN SECTION 7, WASP SHALL NOT BE LIABLE FOR ANY CLAIMS AGAINST END USER BY ANY OTHER PARTY. IN NO EVENT SHALL WASP'S LIABILITY FOR DAMAGES, IF ANY, WHETHER BASED UPON CONTRACT, TORT (INCLUDING NEGLIGENCE), PRODUCT LIABILITY, STRICT LIABILITY, WARRANTY, OR ANY OTHER BASIS, EXCEED THE PRICE OR FEE PAID BY END USER FOR THE WASP PRODUCT. UNDER NO CIRCUMSTANCES SHALL WASP BE LIABLE TO END USER OR ANY THIRD PARTY FOR LOST PROFITS, LOST DATA, INTERRUPTION OF BUSINESS OR SERVICE, OR FOR ANY OTHER SPECIAL, CONSEQUENTIAL, CONTINGENT, INDIRECT, INCIDENTAL, PUNITIVE, EXEMPLARY, OR OTHER SIMILAR DAMAGES, EVEN IF WASP HAS BEEN ADVISED OF THE POSSIBILITY OF SUCH DAMAGES.

## **9. Government Restricted Rights; International Use.**

- 9.1 Use, duplication, or disclosure of the Software by the U.S. Government is subject to the restrictions for computer software developed at private expense as set forth in the U.S. Federal Acquisition Regulations at FAR 52.227-14(g), or 52.227-19 or in the Rights in Technical Data and Computer Software clause at DFARS 252.227-7013(c)(1)(ii), whichever is applicable.
- 9.2 If End User is using the Wasp Product outside of the United States, End User must comply with the applicable local laws of the country in which the Wasp Product is used, with U.S. export control laws, and with the English language version of this Agreement. The provisions of the "United Nations Convention on International Sale of Goods" shall not apply to this Agreement.

## **10. Termination.**

- 10.1 Either party may terminate this Agreement or any license granted under this Agreement at any time upon written notice if the other party breaches any provision of this Agreement.
- 10.2 Upon termination of this Agreement, End User immediately shall cease using any non-embedded software and shall return to Wasp or destroy all non-embedded software covered by this Agreement, and shall furnish Wasp with a certificate of compliance with this provision signed by an officer or authorized representative of End User. For embedded software, End User agrees to sign a waiver prepared by Wasp concerning further use of the embedded Software. End User's resumed or continued use of the embedded Software after termination shall constitute End User's agreement to be bound by the terms and conditions of this Agreement for such use.

## **11. General Provisions.**

- 11.1 Entire Agreement; Amendment. This document contains the entire agreement between the parties relating to the licensing of the Software and supersedes all prior or contemporaneous

aneous agreements, written or oral, between the parties concerning the licensing of the Software. This Agreement may not be changed, amended, or modified except by written document signed by Wasp.

- 11.2 Notice. All notices required or authorized under this Agreement shall be given in writing, and shall be effective when received, with evidence of receipt. Notices to Wasp shall be sent to the attention of Contract Administration, Wasp Barcode Technologies, Inc., 1400 10th Street, Plano, Texas USA 75074, or such other address as may be specified by Wasp in writing.
- 11.3 Waiver. A party's failure to enforce any of the terms and conditions of this Agreement shall not prevent the party's later enforcement of such terms and conditions.
- 11.4 Governing Law; Venue: This Agreement and the rights of the parties hereunder shall be governed by and construed in accordance with the laws of the State of Oregon U.S.A, without regard to the rules governing conflicts of law. The state or federal courts of the State of Oregon located in either Multnomah or Lane counties shall have exclusive jurisdiction over all matters regarding this Agreement, except that Wasp shall have the right, at its absolute discretion, to initiate proceedings in the courts of any other state, country, or territory in which End User resides, or in which any of End User's assets are located.
- 11.5 Attorneys' Fees. In the event an action is brought to enforce the terms and conditions of this Agreement, the prevailing party shall be entitled to reasonable attorneys' fees, both at trial and on appeal.

**- END -**



# Quick Reference

This guide is provided to help get your installation up-and-running quickly and efficiently. For more details, including programming information, reference the Product Reference Guide (PRG), which is available for viewing and download from the website listed on the back cover of this manual.

## Installation

Route the interface cable from the terminal or host. Plug the AC adapter (if one is used) into a wall outlet and the interface (I/F) cable, then route and attach the I/F cable to the scanner. Verify operation by presenting known-good barcodes to the scanner. The unit should beep<sup>1</sup> and/or flash its good read LED and send the barcode data to the host or terminal. If not, refer to the Troubleshooting section of this guide.

Scanner installation is complete.

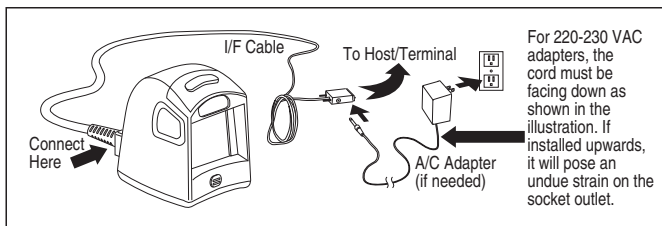

The WSP200 utilizes illumix™ intelligent illumination technology to optimize light levels for a variety of bar code scanner functions including automatic reading of bar codes from printed surfaces, mobile devices and image capture in variable contrast environments.

---

1. Beeper and LED behavior is selectable and may have been disabled by a previous user.

## Optional Stand

An optional stand is available for the scanner which can be permanently attached to a wall or countertop. After locating the stand in an optimal position, the scanner (along with the stand) can be detached for portable use by lifting the entire unit as shown below.

## Power Supply

Models require<sup>1</sup> either a Listed class II or class III with a Limited Power Source (LPS). For the safety certification to be valid, class III input power sources must be IEC/EN60950-1 (EN 60335-series, EN 60065 or relevant) approved.

Input: 100 - 240 VAC

Output: 5 VDC

Max. Current: 2.5 A

Max. Power: 12.5 W

System Input Voltage

Input: 4.5 - 14.0 VDC

Max. Power: 2.5 W

## How to Scan

barcodes can be presented to the scanner while it is resting on the counter or in the optional stand, or the scanner/mount can be lifted and held as shown.

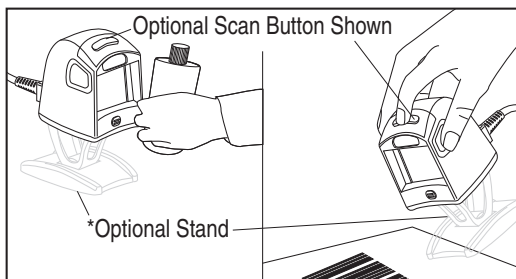

1. Power Off the Terminal (POT) units do not require a power supply.

# Targeted Scanning Mode

In order to read a barcode (button option only)...

- press and hold the scan button. An aiming pattern will appear.
- with the aiming pattern fairly centered over the barcode to be read, release the button to read the label.



## NOTE

The scanner will not read barcodes while the button is pressed.

Targeted Scanning Mode will read barcodes in any orientation.

The scanner will return to full pattern Omni Mode after a configurable time has elapsed.

# Troubleshooting

If the scanner is not operating properly, the following checks should be performed:

1. If the scanner uses an external power supply and the external power supply has failed, the scanner will not operate. Exchange the power supply with a known good power supply and retest operation.

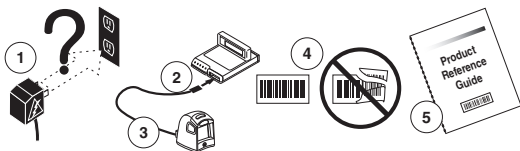

2. Verify the interface cable is securely attached to the host. Consult your technical support personnel or refer to your host system manual to verify the proper connection for the scanner.

3. Verify that the interface cable is securely attached to the scanner.
4. Check that the barcodes are of sufficient quality to be recognized by the scanner. Wrinkled, smudged, or torn labels can cause the scanner to not read at all. Scan known-good labels of an active symbology<sup>1</sup> to check the scanner's read operation.
5. Ensure that the scanner's interface type is compatible with the host terminal by consulting your POS system manual and/or the Product Reference Guide.

If the scanner still does not function properly, contact your local supplier or Customer Support Services.

## Compliance Statement

**This Class B digital apparatus complies with Canadian ICES -003.**

**Cet appareil numérique de la classe B est conforme à la norme NMB-003 du Canada.**

---

1. Reading of the various barcode symbologies can be independently enabled or disabled in the scanner.

# Guida Rapida

La presente guida vi aiuterà ad eseguire un'installazione rapida ed efficace. Per ulteriori dettagli, inclusi i dettagli relativi alla programmazione, consultare la Guida di Riferimento del Prodotto, che può essere consultata online e scaricata dal sito di indicato sul retro del presente manuale.

## Installazione

Svolgere il cavo d'interfaccia dal terminale o host. Inserire l'eventuale adattatore CA nella presa a parete e nel cavo d'interfaccia (I/F), quindi collegare il cavo I/F allo scanner. Verificare il funzionamento facendo leggere allo scanner dei codici a barre dei quali si conosce il contenuto e in buono stato. L'unità emetterà un suono<sup>1</sup> e/o farà lampeggiare il LED che segnala la corretta lettura del codice e invierà i dati del codice all'host o al terminale. In caso contrario, consultare la sezione "Risoluzione dei problemi" della presente guida.

L'installazione dello scanner è completa.

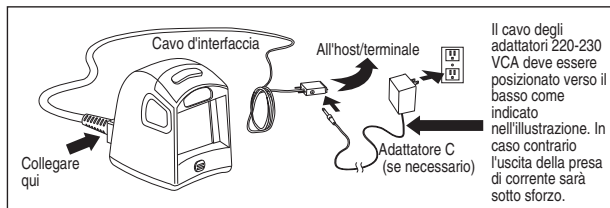

Il WSP200 usa la tecnologia di illuminazione intelligente illumix™ allo scopo di ottimizzare i livelli di luce in molteplici funzionalità dello scanner inclusi: lettura automatica di codici a barre da superfici stampate, dispositivi mobili e image capture in ambienti con contrasto variabile.

1. È possibile selezionare suono oppure LED. Tenere conto della configurazione impostata dall'utente che ha utilizzato lo scanner in precedenza.

## Supporto Opzionale

È disponibile un supporto opzionale che può essere attaccato permanentemente alla parete o sul bancone. Dopo aver posizionato il supporto in posizione ottimale, lo scanner e il supporto potranno essere staccati per l'utilizzo mobile sollevando l'intera unità come illustrato in basso.

## Alimentazione

Questi modelli<sup>1</sup> devono essere alimentati con alimentatori omologati di classe II o classe III LPS (Limited Power Source, sorgente di corrente limitata). Affinché il certificato di sicurezza sia valido, le sorgenti di alimentazione di classe III devono essere conformi a IEC/EN60950-1 (serie EN 60335, EN60065 o relativi).

Tensione ingresso:

100 - 240 VAC

Tensione uscita:

5 VDC

Consumo massimo: 2.5 A

Potenza massima: 12.5 W

Sistema di tensione in ingresso

Tensione ingresso: 4.5 - 14.0 VDC

Potenza massima: 2.5 W

## Come utilizzare lo Scanner

È possibile presentare i codici al lettore, mentre è posizionato sul bancone oppure inserito nel supporto opzionale, oppure lo scanner può essere sollevato come da illustrazione.



1. Le unità alimentate dal terminale (POT - Power Off the Terminal) non richiedono alimentazione di rete.

# Modalità di Scansione a Bersaglio

Per utilizzare lo scanner con il pulsante opzione:

- tenere premuto il pulsante. Apparirà un mirino luminoso.
- Posizionare il mirino luminoso al centro del codice a barre da leggere e rilasciare il pulsante opzione per eseguire la lettura.



## NOTE

**Lo scanner non legge i codici, se il pulsante è premuto.**

**La modalità di scansione bersaglio consente di leggere codici orientati in qualunque verso. Lo scanner ritornerà in modalità Omni dopo un periodo di tempo impostabile.**

## Risoluzione dei Problemi

Nel caso lo scanner non funzionasse correttamente, eseguire i seguenti controlli:

1. Se lo scanner utilizza un'alimentazione esterna e quest'ultima non fosse operativa, lo scanner non funzionerà. Utilizzare una sorgente di alimentazione affidabile e riprovare.

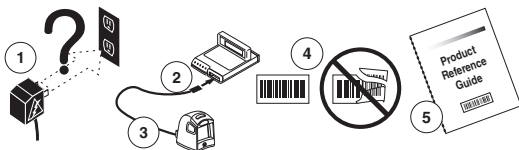

2. Verificare che il cavo d'interfaccia sia saldamente collegato all'host. Consultare il proprio personale tecnico oppure il manuale del sistema host per controllare il corretto collegamento dello scanner.

3. Verificare che il cavo d'interfaccia sia saldamente collegato allo scanner.
4. Controllare che i codici a barre siano di qualità sufficientemente leggibile per lo scanner. Etichette piegate, strappate o sbavate potrebbero non essere leggibili. Utilizzare etichette sicuramente leggibili che appartenengono ad un sistema di simbologia<sup>1</sup> utilizzato per controllare il funzionamento dello scanner in lettura.
5. Assicurarsi che il tipo di interfaccia dello scanner sia compatibile con il terminale/host consultando il manuale del POS e/ o la Guida di riferimento del prodotto.

Se lo scanner non funziona correttamente, contattare il rivenditore locale oppure il Servizio Assistenza Clienti.

## Dichiarazione di Conformità

**Il presente apparato digitale di Classe B è conforme alla normativa canadese ICES-003.**

---

1. La lettura delle varie simbologie dei codici a barre può essere indipendentemente abilitata o disabilitata nello scanner.



# Guía de Referencia Rápida

La finalidad de esta guía es ayudarle a instalar el equipo de forma rápida y eficiente. Para obtener más datos, incluida información de programación, consulte la Guía de referencia del producto (PRG) que podrá ver y descargar de la página Web, cuya dirección aparece en la contracubierta de este manual.

## Instalación

Encamine el cable de interfaz desde el terminal o el equipo central. Conecte el adaptador de CA (si se utiliza uno) a una toma de corriente de pared y al cable de interfaz (I/F). A continuación encamine y conecte el cable I/F al escáner. Para comprobar el funcionamiento, coloque un código de barras en buen estado ante el escáner. La unidad emitirá un pitido<sup>1</sup> y/o parpadeará el LED de lectura correcta y enviará los datos del código de barras al equipo central o al terminal. Si no es así, consulte la sección Solución de averías de esta guía.

La instalación del escáner ha finalizado.

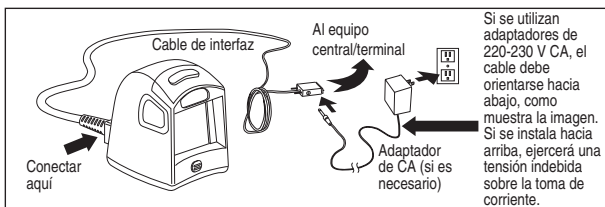

El WSP200 utiliza la tecnología de Iluminación illumix™ la cual perfecciona niveles de luz para una variedad de funciones de un lector de código de barras incluyendo lectura automática de códigos de barras impresos, en pantallas de dispositivos móviles y captura de imágenes en ambientes con contrastes variables.

1. El funcionamiento del indicador acústico y el LED es seleccionable y es posible que un usuario anterior lo haya desactivado.

## Soporte Opcional

Existe un soporte opcional para el escáner que puede acoplarse de forma permanente a una pared o a un mostrador. Después de colocar el soporte en la posición óptima, se podrá desmontar el escáner (junto con el soporte) si desea trasladarlo de lugar. Para ello, solo tiene que elevar la unidad completa, tal y como muestra la imagen.

## Suministro Eléctrico

Se requiere fuente limitada<sup>1</sup> de alimentación (LPS) alistada en la clase II o la clase III para estos modelos. La certificación de seguridad solamente es válida si las enchufadas para fuente de alimentación clase III están aprobadas por IEC-EN60950-1 (serie EN 60335, EN 60065 o comparable).

Enchufada:  
100 - 240 VAC

Despacho:  
5 VDC

Corriente máximo: 2.5 A  
Poder máximo: 12.5 W

Sistema de tensión de entrada

Enchufada: 4.5 - 14.0 VDC

Poder máximo: 2.5 W

## Instrucciones Para Escanear

Los códigos de barras pueden colocarse delante del escáner mientras éste permanece apoyado sobre el mostrador o el soporte opcional. También es posible elevar y sostener el escáner/unidad como muestra la imagen.

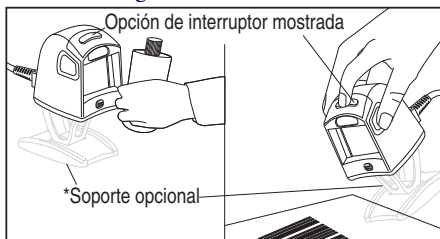

1. Las unidades de desconexión del terminal (POT) no precisan una fuente de alimentación.

# Modo de Exploración de Objetivo

Para leer un código de barras (solo opción de interruptor)...

- Mantenga pulsado el interruptor. Aparecerá un haz para apuntar.
- Centre el haz para apuntar lo más posible sobre el código de barras que vaya a leer y suelte el interruptor para leer la etiqueta.



## NOTA

El escáner no leerá códigos de barras mientras el interruptor permanezca pulsado.

El modo de exploración de objetivo leerá los códigos de barras en cualquier dirección.

El escáner volverá al modo de haz completo una vez que haya transcurrido un tiempo configurable.

# Solución de Problemas

Si el escáner no funciona correctamente, deberán realizarse las siguientes comprobaciones:

1. Si el escáner utiliza una fuente de alimentación externa y dicha fuente se ha averiado, el escáner no funcionará. Cambie la fuente de alimentación por otra en buen estado y restablezca el funcionamiento.

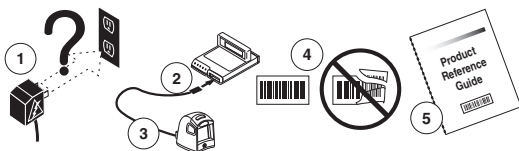

2. Compruebe que el cable de interfaz está perfectamente acoplado al equipo central. Pida ayuda al personal de asistencia técnica o consulte el manual del sistema central para comprobar que el escáner esta correctamente conectado.

3. Compruebe que el cable de la interfaz está perfectamente acoplado al escáner.
4. Compruebe que los códigos de barras tienen la calidad suficiente para ser reconocidos por el escáner. El escáner no leerá etiquetas arrugadas, emborronadas o rasgadas. Para comprobar el funcionamiento de la función de lectura del escáner, explore etiquetas que contengan una simbología activa en buen estado<sup>1</sup>.
5. Asegúrese de que el tipo de interfaz del escáner es compatible con el terminal central. Para ello, consulte el manual del sistema POS y/o la Guía de referencia del producto.

Si el escáner sigue sin funcionar correctamente, póngase en contacto con su proveedor local o con el Departamento de Atención al Cliente.

## Nota de Conformidad

**Este aparato digital de Clase B cumple la normativa canadiense ICES -003.**

---

1. La lectura de distintas simbologías de códigos de barras puede activarse o desactivarse de forma independiente en el escáner.

# Referência Rápida

Este guia é fornecido para ajudar a ter sua instalação funcionando rápida e eficientemente. Para obter maiores detalhes, incluindo informações de programação, consultar o Guia de Referência do Produto (PRG), que está disponível para visualização e download a partir do web-site listado na contracapa deste manual.

## Instalação

Rotear o cabo de interface a partir do terminal ou do host. Ligar o adaptador C.A. (se for usado um) em uma tomada na parede e o cabo de interface (I/F), então rotear e conectar o cabo I/F ao leitor. Verificar a operação apresentando códigos de barra em bom estado e reconhecidos pelo leitor. A unidade deve emitir um bip<sup>1</sup> e/ou lampear sua boa leitura, enviando os dados de código de barras para o host ou terminal. Caso contrário, consultar a seção Diagnóstico deste guia.

A instalação do leitor está completa.

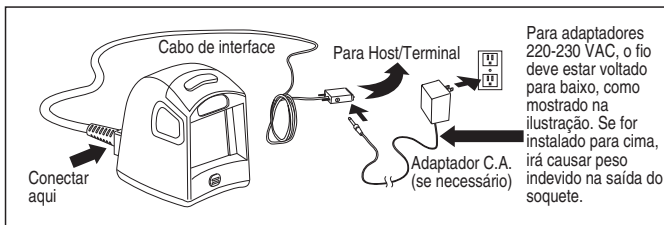

O WSP200 utiliza tecnologia de Iluminação illumix™ que otimiza níveis de luz para uma variedade de funções de um leitor de código de barras, incluindo a leitura automática de códigos de barras impressos, em telas de dispositivos móveis e captura de imagens em ambientes com contrastes variáveis.

1. O comportamento do bip e do LED pode ser selecionado e pode estar desabilitado por um usuário anterior.

## Suporte Opcional

Um suporte opcional está disponível para o leitor, que pode ser conectado permanentemente a uma parede ou um balcão. Após localizar o balcão em uma boa posição, o leitor (paralelo ao balcão) pode ser destacado para uso portátil, levantando a unidade como mostrado abaixo.

## Adaptador C.A / C.C.

Modelos podem ser classificados<sup>1</sup> como Classe II ou Classe III, com Fonte de Energia Limitada (LPS). Para o certificado de segurança elétrica ser válido, uma fonte de entrada de energia Classe III precisa ser aprovada como IEC/EN60950-1 (EN 60335-serie, EN 60065 ou relevante).

Entrada:  
100 - 240 V c.a.

Saída:  
5 VDC

Corrente Max.: 2.5 A  
Potencia Max.: 12.5 W

Sistema de tensão de entrada

Entrada: 4.5 - 14.0 VDC

Potencia Max.: 2.5 W

## Como Fazer Leitura

Os códigos de barra podem ser apresentados ao leitor enquanto este está no balcão ou na suporte opcional, ou o leitor/montagem pode ser levantado e segurado como mostrado abaixo.



1. Fornecimento de energia das unidades do tipo POT não exigem uma fonte de energia externa.

# Modo de Leitura Direcionada

Para ler um código de barra (somente opção de botão)...

- Pressionar e segurar o botão. Um padrão almejado irá aparecer.
- Com o padrão almejado centrado no código de barra para ser lido, soltar o botão para ler a etiqueta.



## NOTA

O leitor não irá ler códigos de barra enquanto o botão estiver pressionado.

Modo de Leitura Etiquetado irá ler códigos de barra em qualquer orientação.

O leitor irá retornar para o padrão total Omni Mode depois que um tempo configurável tiver passado.

# Diagnóstico

Se o leitor não estiver operando de forma apropriada, as seguintes to verificações devem ser realizadas:

1. Se o leitor usar um fornecimento de energia externo e este estiver falhando, o leitor não irá operar. Trocar o fornecedor de energia com um reconhecidamente bom e testar novamente a operação.

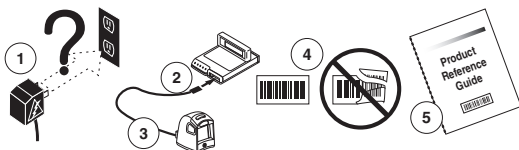

2. Verificar se o cabo de interface está conectado com segurança ao host. Consultar seu suporte técnico ou o manual do sistema host para verificar a conexão apropriada para o leitor.

3. Verificar se o cabo de interface está conectado de forma segura ao leitor.
4. Verificar se os códigos de barra são de qualidade suficiente para serem reconhecidos pelo leitor. Etiquetas dobradas, manchadas ou molhadas podem fazer com que o leitor não as leia. Fazer o scan de etiquetas boas de uma simbologia<sup>1</sup> para verificar a operação de leitura do leitor.
5. Garantir que o tipo de interface do leitor é compatível com o terminal host, consultando seu manual do sistema PDV e/ou o Guia de Referência do Produto.

Se o leitor não funcionar ainda adequadamente, contactar seu fornecedor local ou os Serviços de Suporte ao Cliente.

## Declaração de Conformidade

**Este equipamento digital Classe B atende à norma Canadense ICES -003.**

---

1. A leitura de várias simbologias de código de barra pode ser independentemente habilitada ou desabilitada no leitor.



# Guide de Référence Rapide

Ce guide est fourni afin de vous aider à installer rapidement et efficacement votre lecteur de codes à barres. Pour plus de détails concernant les informations sur la programmation, consultez le Guide de Référence du Produit qui est disponible soit pour lecture soit pour téléchargement à partir du site Internet indiqué au dos de ce manuel.

## Installation

Acheminez le câble d'interface à partir du terminal ou de l'ordinateur hôte. Branchez l'adaptateur CA (courant alternatif) (s'il est nécessaire d'en utiliser un) à une prise du mur et le câble d'interface (I/F), ensuite acheminez et connectez le câble I/F au scanner. Vérifiez l'opération en présentant au scanner des codes à barres corrects. L'unité devrait émettre un bip<sup>1</sup> sonore et/ou faire clignoter la diode pour confirmer que la saisie est correcte et envoyez les données du codes à barres à un ordinateur hôte ou au terminal. Si ce n'est pas le cas, consultez la section Diagnostic de Pannes de ce guide.

L'installation du scanner est terminée.

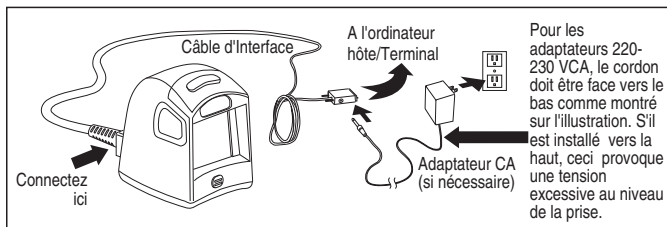

Le scanner WSP200 fonctionne avec la technologie dernière génération d'illumination intelligente illumix™, qui permet d'optimiser les niveaux de lumière automatiquement pour permettre une agressivité de lecture inégalée des codes sur papier et écran d'appareils portables ainsi que la capture d'images quelque soit la luminosité.

1. Le bip sonore et le clignotement de la diode LED peuvent être sélectionnés et peuvent avoir été désactivés par un utilisateur précédent.

# Support Facultatif

Un support facultatif est disponible pour le scanner qui peut être fixé en permanence à un mur ou à un comptoir. Après avoir placé le support dans une position optimale, le scanner (ainsi que le support) peuvent être détachés pour un usage portatif en levant l'unité complète comme illustré ci-dessous.

## Alimentation Électrique

Modèles<sup>1</sup> référencés Classe II et Classe III nécessitant une alimentation externe (Limited Power Source). Afin de valider le certificat de sécurité, l'alimentation classe III doit être certifiée IEC/EN60950-1 (Séries EN 60335, EN 60065 ou équivalent).

Tension d'entrée:

100 - 240 VAC

Tension de sortie:

5 VDC

Max. de courant: 2.5 A

La puissance max.: 12.5 W

### Système de tension d'entrée

Tension d'entrée: 4.5 -

14.0 VDC

La puissance max.: 2.5 W

## Comment Scanner

La lecture peut être en mode mains libres pour les pièces faciles à manipuler ou à la main pour les pièces plus encombrantes.

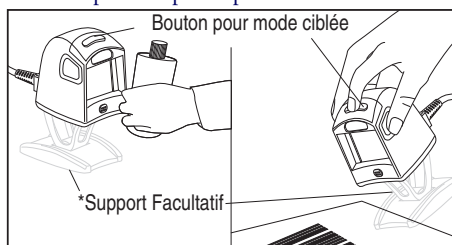

1. Les unités de mise hors tension du terminal n'exigent aucune alimentation électrique.

# Mode Saisie Ciblée

Afin de saisir un code-barre (option commutation uniquement)...

- appuyez et maintenez la pression sur le bouton de commutation. Un rayon de visée apparaîtra.
- centrez bien le rayon de visée au-dessus du codes à barres qui doit être saisi, puis relâchez le bouton pour lire l'étiquette.



## NOTE

Le scanner ne lira pas les codes à barres tant que le bouton sera enfoncé. Le Mode de Saisie Ciblée lira les codes à barres dans n'importe quel sens. Le scanner retournera complètement en mode Omni après qu'un certain temps configurable se sera écoulé.

# Diagnostic de Pannes

Si le lecteur ne fonctionne pas correctement, effectuez les vérifications suivantes :

1. Si le lecteur utilise une alimentation électrique extérieure et que l'alimentation extérieure ne fonctionne pas, le lecteur ne fonctionnera pas. Echangez la source d'alimentation avec une autre alimentation électrique correcte et effectuez de nouveau l'opération pour vérification.

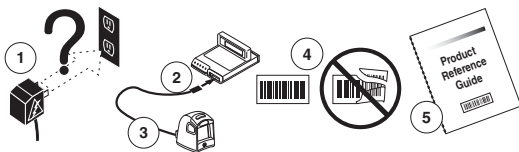

2. Vérifiez que le câble d'interface est correctement connecté à l'ordinateur hôte/terminal. Consultez votre service technique ou référez-vous au manuel de votre ordinateur hôte afin de vérifier si la connexion au lecteur est correcte.

3. Vérifiez que le câble d'interface est connecté correctement au lecteur.
4. Contrôlez que la qualité des codes à barres est suffisante pour que ceux-ci soient reconnus par le scanner. Les étiquettes pliées, sales ou déchirées peuvent empêcher le scanner de lire les codes. Saisissez des étiquettes correctes avec une symbologie<sup>1</sup> active afin de vérifier que le scanner effectue l'opération de saisie correctement.
5. Assurez-vous que le type d'interface du scanner est compatible avec le terminal hôte en consultant la manuel de votre système POS et/ou le Guide de Référence du Produit.

Si le lecteur ne fonctionne toujours pas correctement, contactez votre fournisseur local ou le Service d'Assistance Clientèle.

## Déclaration de Conformité

**This Class B digital apparatus complies with Canadian ICES -003.**

**Cet appareil numérique de la classe B est conforme à la norme NMB-003 du Canada.**

---

1. La lecture des différentes symbologies et de codes à barres peuvent être activées ou désactivées de façon indépendante.

# Schnellanleitung

Diese Anleitung soll eine schnelle und effiziente Installation und Inbetriebnahme ermöglichen. Weitere Einzelheiten, u.a. zur Programmierung, entnehmen Sie dem Produktleitfaden (Product Reference Guide, PRG), der zum Anzeigen und Herunterladen auf der Webseite verfügbar ist (siehe Rückseite dieses Leitfadens).

## Installation

Verlegen Sie das Interfacekabel vom Haupt- oder Endgerät. Schließen Sie den Netzadapter (sofern verwendet) an einer Netzsteckdose und am Interfacekabel (IF-Kabel) an, und verlegen Sie das IF-Kabel zum Scanner und schließen es daran an. Führen Sie einen Funktionstest aus, indem Sie mit dem Scanner garantiert funktionsfähige Barcodes einlesen. Das Gerät muss einen Piepton<sup>1</sup> aussenden und/oder mit der gut sichtbaren LED blinken und die Barcodedaten an das End- oder Hauptgerät senden. Andernfalls ziehen Sie den Abschnitt zu Fehlerbehebung in diesem Leitfaden zurate.

Die Scannerinstallation ist abgeschlossen.

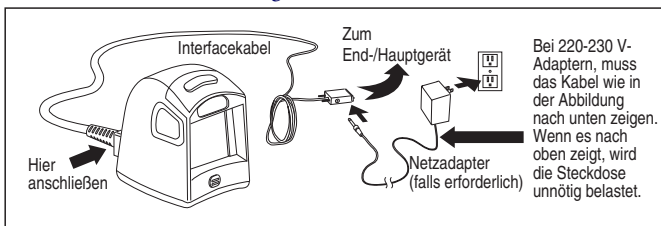

Der WSP200 verwendet die intelligente Beleuchtungstechnologie illumix™ und optimiert so die automatische Erfassung bei einer Vielzahl von Barcodescannerfunktionen. Hierzu gehört das Lesen von gedruckten Barcodes sowie von Barcodes auf mobilen Endgeräten und die Bilderfassung in Umgebungen mit unterschiedlich starker Beleuchtung.

1. Piepton- und LED-Verhalten können eingestellt werden und sind durch Vornutzer ggf. deaktiviert.

## Optionaler Ständer

Zu dem Scanner gibt es einen optionalen Sockel zur dauerhaften Befestigung an einer Wand oder Ladentheke. Nachdem Sie den Sockel optimal positioniert haben, können Sie den Scanner (mit Sockel) für freihändigen Einsatz abnehmen, indem Sie das gesamte Gerät wie unten dargestellt anheben.

## Stromversorgung

Die Modelle<sup>1</sup> erfordern eine Stromquelle der Klasse II oder III mit einer Leistungsbegrenzung (LPS). Für eine gültige Sicherheitszertifizierung müssen Klasse III Stromquellen am Eingang nach den Bestimmungen IEC/EN60950-1 (EN 60335-Serien, EN 60065 oder entsprechenden) zugelassen sein.

Eingang:  
100 - 240 VAC

Ausgang:  
5 VDC

Max. Strom: 2.5 A  
Max. Leistung: 12.5 W

System Eingangsspannung

Eingang: 4.5 - 14.0 VDC

Max. Leistung: 2.5 W

## Scanverfahren

Barcodes werden mit dem Scanner eingescannt, während dieser auf der Ladentheke steht oder am optionalen Sockel befestigt ist, oder indem der Scanner/die Halterung hochgehoben und wie folgt gehalten wird.

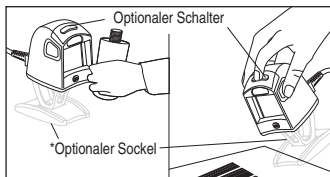

---

1. Für Geräte mit POT-Option (Power Off the Terminal) ist keine Stromversorgung erforderlich.

# Zielscanmodus

So lesen Sie einen Barcode ein (nur optionaler Schalter):

- Schalter gedrückt halten Ein Zielmuster wird angezeigt.
- Zielmuster entsprechend über dem einzulesenden Barcode ausrichten und Schalter zum Scannen des Etiketts loslassen.



Bei gedrücktem Schalter werden die Barcodes vom Scanner nicht eingelesen.

Mit dem Zielscanmodus werden Barcodes in jeder Ausrichtung eingelesen.

## HINWEIS

Der Scanner wechselt nach Ablauf einer konfigurierbaren Zeit wieder in den omnidirektionalen Vollmustermodus.

# Fehlerbehebung

Bei fehlerhaftem Scannerbetrieb prüfen Sie Folgendes:

1. Wenn der Scanner mit einer externen Stromversorgung betrieben wird, funktioniert er nicht, wenn diese ausfällt. Stromversorgung durch ein garantiert funktionsfähiges Gerät ersetzen und Betrieb testen.

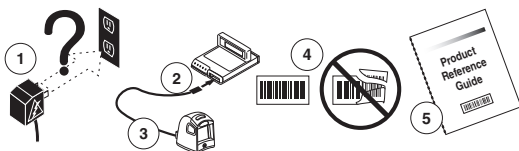

2. Sicherstellen, dass das Interfacekabel am Endgerät richtig angeschlossen ist. Wenden Sie sich an Ihr zuständiges Technikpersonal oder ziehen Sie das Endgeräthandbuch zurate, um einen ordnungsgemäßen Anschluss des Scanners sicherzustellen.

3. Sicherstellen, dass das Interfacekabel am Scanner richtig angeschlossen ist.
4. Sicherstellen, dass die Barcodes ausreichende Qualität aufweisen, um vom Scanner erkannt zu werden. Zerknitterte, beschmierte, oder angerissene Etiketten machen ein Einlesen unmöglich. Scannen Sie garantiert gute Etiketten mit aktiver Symbologie<sup>1</sup>, um die Einlesefunktion des Scanners zu überprüfen.
5. Vergewissern Sie sich, dass der Schnittstellentyp des Scanners mit dem Endgerät kompatibel ist, indem Sie das Handbuch des POS-Systems und/oder den Produktleitfaden (Product Reference Guide) zurate ziehen.

Wenn der Scanner weiterhin nicht ordnungsgemäß funktioniert, wenden Sie sich an Ihren örtlichen Händler oder an den Kundensupport.

## Erfüllung von Vorschriften

Dieses Digitalgerät der Klasse B entspricht dem kanadischen Standard ICES -003.

---

1. Das Einlesen der verschiedenen Barcodesymbolgien kann im Scanner unabhängig aktiviert bzw. deaktiviert werden.



## FCC Statement

This Equipment has been tested and found to comply with the limits for a Class B digital device, pursuant to part 15 of the FCC Rules. These limits are designed to provide reasonable protection against harmful interference in a residential installation. This equipment generates uses and can radiate radio frequency energy and, if not installed and used in accordance with these instructions, may cause harmful interference to radio communications. However, there is no guarantee that interference will not occur in a particular installation. If this equipment does cause harmful interference to radio or television reception, which can be determined by turning the equipment off and on, the user is encouraged to try to correct the interference by one or more of the following measures:

- Reorient or relocate the receiving antenna
- Increase the separation between the equipment and receiver
- Connect the equipment into an outlet on a circuit different from that to which receiver is connected
- Consult the dealer or an experienced radio / TV technician for help.



**CAUTION**

**The User is cautioned that changes or modifications not expressly approved by the part responsible for compliance could void the user's authority to operate the equipment.**

## Warranty

Wasp warrants to Customer that this product will be free from defects in materials and workmanship for a period of 2years from product shipment.

### Wasp Limited Factory Warranty

#### Warranty Coverage

Wasp hardware products are warranted against defects in material and workmanship under normal and proper use. The liability of Wasp under this warranty is limited to furnishing the labor and parts necessary to remedy any defect covered by this warranty and restore the product to its normal operating condition. Repair or replacement of product during the warranty does not extend the original warranty term. Products are sold on the basis of specifications applicable at the time of manufacture and Wasp has no obligation to modify or update products once sold.

If Wasp determines that a product has defects in material or workmanship, Wasp shall, at its sole option repair or replace the product without additional charge for parts and labor, or credit or refund the defective products duly returned to Wasp. To perform repairs, Wasp may use new or reconditioned parts, components, subassemblies or products that have been tested as meeting applicable specifications for equivalent new material and products. Customer will allow Wasp to scrap all parts removed from the repaired product. The warranty period shall extend from the date of shipment from Wasp for the duration published by Wasp for the product at the time of purchase (Warranty period). Wasp warrants repaired hardware devices against defects in workmanship and materials on the repaired assembly for a 90 day period starting from the date of shipment of the repaired product from Wasp or until the expiration of the original warranty period, whichever is longer. Wasp does not guarantee, and it is not responsible for, the maintenance of, damage to, or loss of configurations, data, and applications on the repaired units and at its sole discretion can return the units in the "factory default" configuration or with any software or firmware update available at the time of the repair (other than the firmware or software installed during the manufacture of the product). Customer accepts responsibility to maintain a back up copy of its software and data.

#### Warranty Claims Process

In order to obtain service under the Factory Warranty, Customer must notify Wasp of the claimed defect before the expiration of the applicable Warranty period and obtain from Wasp a return authorization number (RMA) for return of the product to a designated Wasp service center. If Wasp determines Customer's claim is valid, Wasp will repair or replace product without additional charge for parts and labor. Customer shall be responsible for packaging and shipping the product to the designated

Wasp service center, with shipping charges prepaid. Wasp shall pay for the return of the product to Customer if the shipment is to a location within the country in which the Wasp service center is located. Customer shall be responsible for paying all shipping charges, duties, taxes, and any other charges for products returned to any other locations. Failure to follow the applicable RMA policy, may result in a processing fee. Customer shall be responsible for return shipment expenses for products which Wasp, at its sole discretion, determines are not defective or eligible for warranty repair.

## **Warranty Exclusions**

The Wasp Factory Warranty shall not apply to:

- (i) any product which has been damaged, modified, altered, repaired or upgraded by other than Wasp service personnel or its authorized representatives;
- (ii) any claimed defect, failure or damage which Wasp determines was caused by faulty operations, improper use, abuse, misuse, wear and tear, negligence, improper storage or use of parts or accessories not approved or supplied by Wasp;
- (iii) any claimed defect or damage caused by the use of product with any other instrument, equipment or apparatus;
- (iv) any claimed defect or damage caused by the failure to provide proper maintenance, including but not limited to cleaning the upper window in accordance with product manual;
- (v) any defect or damage caused by natural or man-made disaster such as but not limited to fire, water damage, floods, other natural disasters, vandalism or abusive events that would cause internal and external component damage or destruction of the whole unit, consumable items;
- (vi) any damage or malfunctioning caused by non-restoring action as for example firmware or software upgrades, software or hardware reconfigurations etc.;
- (vii) the replacement of upper window/cartridge due to scratching, stains or other degradation and/or
- (viii) any consumable or equivalent (e.g., cables, power supply, batteries, keypads, touch screen, triggers etc.).

## **No Assignment**

Customer may not assign or otherwise transfer its rights or obligations under this warranty except to a purchaser or transferee of product. No attempted assignment or transfer in violation of this provision shall be valid or binding upon Wasp.

WASP'S LIMITED WARRANTY IS IN LIEU OF ALL OTHER WARRANTIES, EXPRESS OR IMPLIED, ORAL OR WRITTEN, STATUTORY OR OTHERWISE, INCLUDING, WITHOUT LIMITATION, ANY IMPLIED WARRANTIES OF MERCHANTABILITY, FITNESS FOR A PARTICULAR PURPOSE, OR NONINFRINGEMENT. WASP SHALL NOT BE LIABLE FOR ANY DAMAGES SUSTAINED BY CUSTOMER ARISING FROM DELAYS IN THE REPLACEMENT OR REPAIR OF PRODUCTS UNDER THE ABOVE. THE REMEDY SET FORTH IN THIS WARRANTY STATEMENT IS THE CUSTOMER'S SOLE AND EXCLUSIVE REMEDY FOR WARRANTY CLAIMS. UNDER NO CIRCUMSTANCES WILL WASP BE LIABLE TO CUSTOMER OR ANY THIRD PARTY FOR ANY LOST PROFITS, OR ANY INCIDENTAL, CONSEQUENTIAL IN-DIRECT, SPECIAL OR CONTINGENT DAMAGES REGARDLESS OF WHETHER WASP HAD ADVANCE NOTICE OF THE POSSIBILITY OF SUCH DAMAGES.

## **Risk of Loss**

Customer shall bear risk of loss or damage for product in transit to Wasp. Wasp shall assume risk of loss or damage for product in Wasp's possession. In the absence of specific written instructions for the return of product to Customer, Wasp will select the carrier, but Wasp shall not thereby assume any liability in connection with the return shipment.



**Wasp Barcode Technologies 1400 10th St Plano, TX 75074 USA**

La presente dichiarazione di conformità è rilasciata sotto la responsabilità esclusiva di Wasp Barcode Technologies. per:  
This Declaration of Conformity is issued under the sole responsibility of Wasp Barcode Technologies for:  
Cette déclaration de conformité est établie sous la seule responsabilité de Wasp Barcode Technologies:  
Diese Konformitätserklärung wird unter der alleinigen Verantwortung des Wasp Barcode Technologies erteilt für:  
Esta declaración de conformidad se expide bajo la exclusiva responsabilidad de Wasp Barcode Technologies para:

**WPS200**

e tutti i suoi modelli sono conformi alle Direttive del Consiglio Europeo sottoelencate:  
and all its models are in conformity with the requirements of the European Council Directives listed below:  
et tous ses modèles sont conformes aux spécifications des Directives de l'Union Européenne ci-dessous:  
und seine Modelle den nachstehenden angeführten Direktiven des Europäischen Rats:  
y todos sus modelos cumple con los requisitos de las Directivas del Consejo Europeo, según la lista siguiente:

**2004/108/EC EMC Directive  
2011/65/EC RoHS Directive (8 June 2012)**

Basate sulle legislazioni degli Stati membri in relazione alla compatibilità elettromagnetica ed alla sicurezza dei prodotti.

On the approximation of the laws of Member States relating to electromagnetic compatibility and product safety.

Basée sur la législation des Etats membres relative à la compatibilité électromagnétique et à la sécurité des produits.

Über die Annäherung der Gesetze der Mitgliedsstaaten in bezug auf elektromagnetische Verträglichkeit und Produktsicherheit entsprechen.

Basado en la aproximación de las leyes de los Países Miembros respecto a la compatibilidad electromagnética y las Medidas de seguridad relativas al producto.

Questa dichiarazione è basata sulla conformità dei prodotti alle norme seguenti:

This declaration is based upon compliance of the products to the following standards:

Cette déclaration repose sur la conformité des produits aux normes suivantes:

Diese Erklärung basiert darauf, daß das Produkt den folgenden Normen entspricht:

Esta declaración se basa en el cumplimiento de los productos con las siguientes normas:

EN 55022 (CLASS B ITE), SEPTEMBER 2006:  
AMENDMENT A1 (CLASS B ITE) OCTOBER 2007

LIMITS AND METHODS OF MEASUREMENT OF RADIO DISTURBANCE  
CHARACTERISTICS OF INFORMATION TECHNOLOGY EQUIPMENT

EN 55024, SEPTEMBER 1998:  
AMENDMENT A2:JUNE 2003

INFORMATION TECHNOLOGY EQUIPMENT- IMMUNITY CHARACTERISTICS  
LIMITS AND METHODS OF MEASUREMENT

EN 60950-1, APRIL 2006 + A11:2009  
+A1 :2010+A12:2011

INFORMATION TECHNOLOGY EQUIPMENT -SAFETY-PART 1 : GENERAL  
REQUIREMENTS

EN50581, Sept 2012

TECHNICAL DOCUMENTATION FOR THE ASSESSMENT OF ELECTRICAL  
AND ELECTRONIC PRODUCTS WITH RESPECT TO THE RESTRICTION OF  
HAZARDOUS SUBSTANCES

Plano, Texas, UPDATED August, 2013

Jeff Schmeling  
Vice President — Product Development



[www.waspbarcode.com](http://www.waspbarcode.com)

Wasp Barcode Technologies  
1400 10th Street  
Plano, Texas USA 75074



820045590 (Rev. D)

August 2013